

Information

This drawing is © C4 Projects and is not to be copied, reproduced or re-distributed either in whole or in part without the prior written permission of the originator.

The originator shall have no responsibility for any liability, loss, cost, damage or expense arising from or relating to any use of this document other than for its intended purpose on this project.

This drawing shall be read in conjunction with all other relevant drawings, specifications and associated documentation. Any discrepancies, errors or omissions are to be reported to the originator before proceeding with work.

All dimensions are to be checked on site by the contractor prior to proceeding with any work. This drawing shall not be scaled to ascertain any dimensions, work to figured dimensions only.

DISCLAIMER
 When this drawing is issued in CAD, it is an uncontrolled version issued for information only. To enable the recipient to prepare their own documents/drawings for which they are solely responsible.

SOFTWARE INTEROPERABILITY
 C4 Projects prepared this drawing using Autodesk REVIT Architecture.

C4 Projects does not accept liability for any loss or degradation of any information held in the drawing resulting from the transition from the original file format to any other file format or from the recipient's reading of it in any other programme.

Hazard Identification		
ref	hazard	date

Indicative Number of Desks	
Level	Count
Level 1	369
Level 2	369

Total number of desks: 738

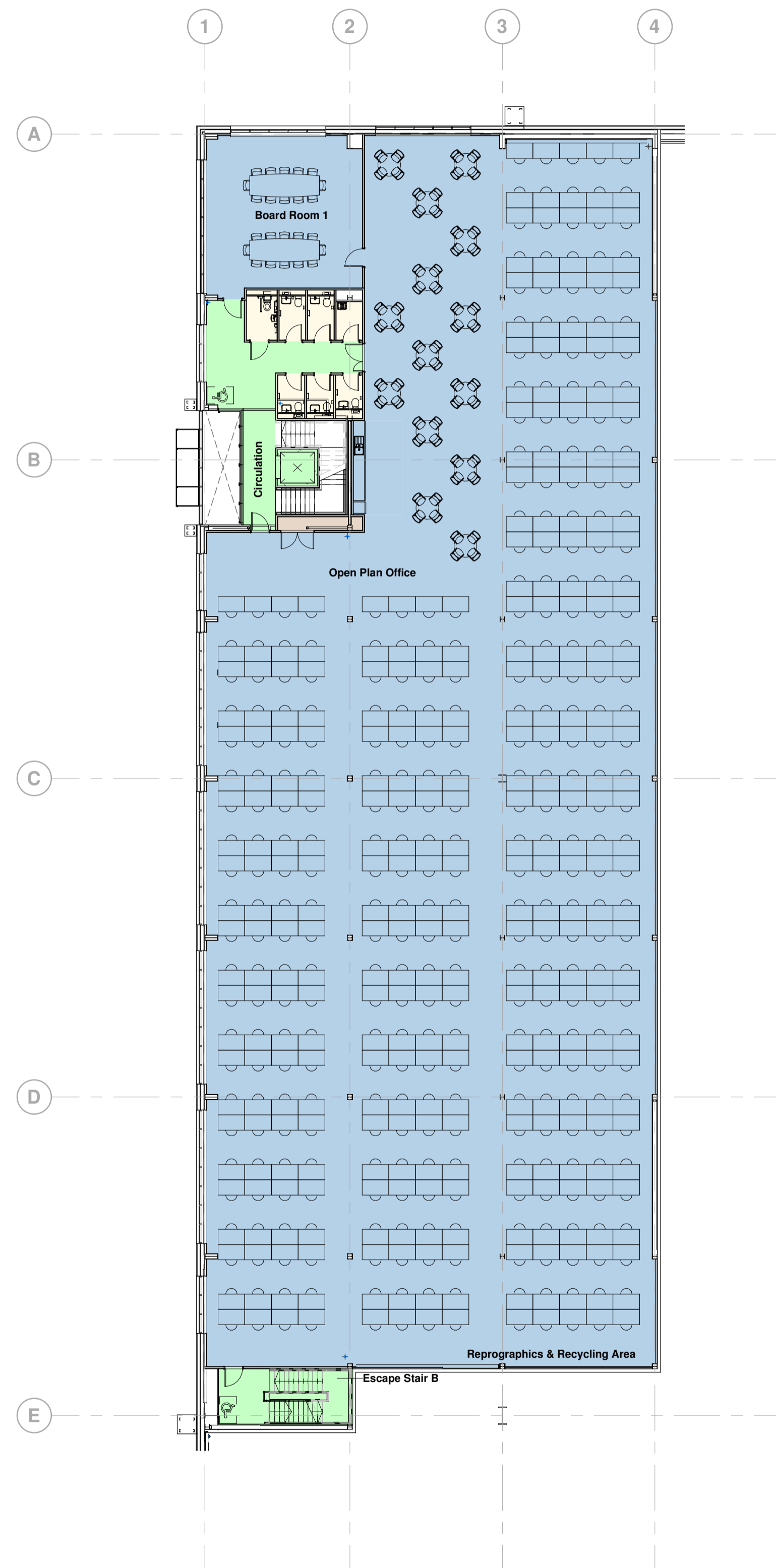

1 70-01 Furniture Layout Plan - Level 01
 1:200

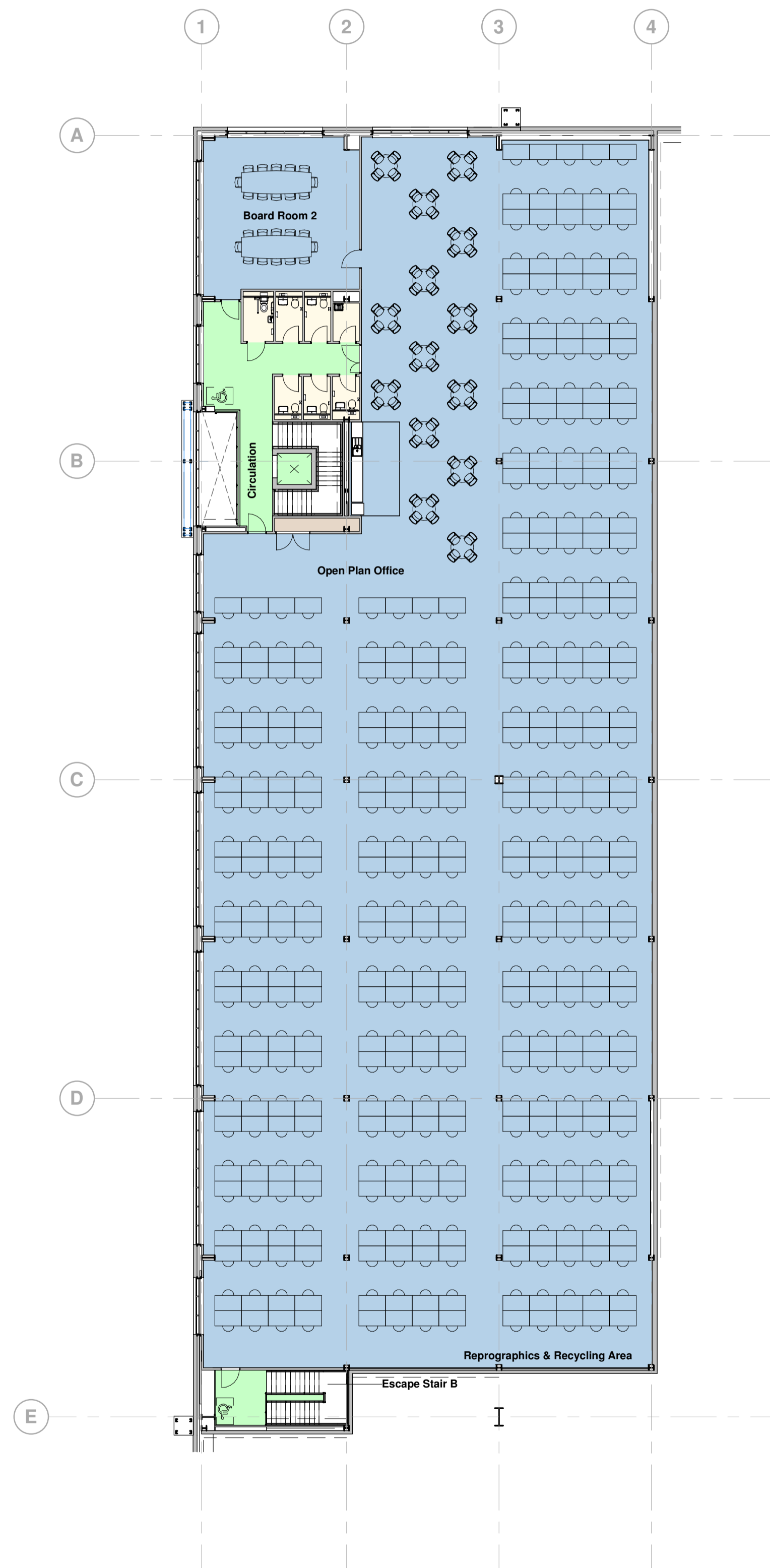

2 70-02 Furniture Layout Plan - Level 02
 1:200

Rev	Revision Details	Drawn	Date	Checked
P1	First Issue	LG	16.12.22	BC

C4 Projects
 Quayside, Widnespool Business Park, Stockton Heath, Warrington, Cheshire, WA4 6SL
 t: 01925 751 852
 e: info@c4projects.co.uk
 www.c4projects.co.uk

Project Management • Architecture • Building Surveying • Cost Consultancy

Client
 HPREF | Konekt Investments S.a r.l. & Harworth Group plc

Project
 Konekt
 Knottingley

Drawing Title
 Unit 1 - Indicative Office Furniture Layout Plan

Status Purpose of Issue
 S2 SUITABLE FOR INFORMATION

Drawn by LG **Created** December 22
C4 Job no. 21078 **Scale** 1:200 @ A1

Dwg no.	Rev
21078-C4P-U1-ZZ-DR-A-7003	P1